

# Origo™ Mag C171/C201/C251

## Welding machines for everyone

**High quality welding machines for high quality results. The ESAB Origo™ Mag C171, C201 and C251 are step regulated welding power sources for MIG/MAG welding. A built-in wire feeder and the low weight of the units make them perfect, practical solutions for use on farms, in repair shops and for light production applications.**

### MIG/MAG welding

Origo™ Mag C171, C201 and C251 can be used with both conventional solid wire and self-shielding cored wire. They are designed for welding both steel, stainless steel and aluminium as well as for Mig brazing.

Wire diameters from 0.6 mm up to 1.2 mm can be used depending on the machine selected.

### Easy to use

The units are equipped with multi-step voltage switches and potentiometers for wire speed adjustment, enabling easy setting of the welding parameters.

It is possible to adjust burnback time and to set spot welding time in all three Origo™ Mags. The units are also fan-cooled and equipped with thermal overload protection.

As an option the Origo™ Mags can be equipped with V/A digital meter and transformer for a CO<sub>2</sub> heater.

### Power Smoothing Device™

Although Origo™ Mag C171, C201 and C251 are 1-ph units, Power Smoothing Device™ gives them excellent welding performance in CO<sub>2</sub> and gas mixtures. Power Smoothing Device™ provides a smooth welding current, comparable to that of a 3-phase machine.



### Torch included

Each machine is equipped with an ergonomically designed, gas-cooled MXL™ Torch with spring loaded contact pins in the central connector (MXL™ 200 for C171 & C201, MXL™ 270 for C251).

Optimum cooling of the torch gives an extended life to the swan neck and the wear parts. Three different version of gas nozzle are available, standard, straight and conical for maximum flexibility.

## Applications

- **Agricultural applications**
- **Auto-repair**
- **Light metal fabrication**
- **Transport**
- **Education**
- **Household and furniture**
- **Tack welding**

- **Power Smoothing Device™** - provides excellent welding performance from a single phase machines
- **Easy change of polarity** - allows the use of both conventional solid wire and self-shielding cored wire
- **Easy setting of welding parameters** - welding machines for everyone
- **MXL™ Torches** - designed to provide the ultimate in convenience and versatility

## Technical data

	Origo™ Mag C171	Origo™ Mag C201	Origo™ Mag C251
<b>Mains voltage , V, Hz</b>	230 1ph 50/60	230 1ph 50/60	230 1ph 50/60
<b>Fuse, A-slow</b>	16	20	35
<b>Auto fuse (MCB) EN 60898</b>			
typ D, A	16*	20*	32*
<b>Permitted load at</b>			
20% duty cycle, A	170	200	250
23-30 % duty cycle, A	155 @ 25%	185 @ 23%	200 @ 30%
60% duty cycle, A	98	115	140
100% duty cycle, A	76	90	110
<b>Setting range (DC) , A</b>	30 - 170	30 - 200	40 - 250
<b>Open circuit voltage , V</b>	22,5 - 44,5	19,6 - 44,9	19,0 - 41,5
<b>Open circuit power , W</b>	270	120	200
<b>Power factor at maximum current</b>	0,91	0,89	0,92
<b>Wire feed speed, m/min</b>	1,0 - 17	1,0 - 17	1,9 - 19
<b>Wire diameter, mm</b>			
Fe, Ss	0,6 - 0,8	0,6 - 1,0	0,6 - 1,2
C	0,8	0,8 - 1,0	0,8 - 1,2
Al	1,0	1,0	1,0 - 1,2
CuSi	0,8 - 1,0	0,8 - 1,0	0,8 - 1,0
<b>Burnback time, s</b>	0,02 - 0,25 (adj.on the PCB)	0,02 - 0,25 (adj.on the PCB)	0 - 0,25
<b>Spot welding, s</b>	0,2 - 2,5	0,2 - 2,5	0,2 - 2,5
<b>Voltage steps</b>	8	12	12
<b>Inductance outlets</b>	1	1	1
<b>Polarity change</b>	YES	YES	YES
<b>Dimensions lwxhx, mm</b>	860x 420 x 730	860 x 420 x 730	860 x 420 x 730
<b>Weight, kg</b>	59	68	94
<b>Operating temperature, °C</b>	-10 to +40	-10 to +40	-10 to +40
<b>Enclosure class</b>	IP 23	IP 23	IP 23
<b>Application classification</b>	S	S	S

\*since „time - current characteristics“ of fuses are spread within some scatter band -in certain cases it may be necessary to reduce the actual top current duty cycle X[%] to some value within limits of 5-20% or to reduce accordingly maximum welding current.

## Ordering information

Origo™ Mag C171 (230V 1 ph 50/60 Hz)	0349 311 280
Origo™ Mag C201 (230V 1 ph 50/60 Hz)	0349 311 290
Origo™ Mag C251 (230V 1 ph 50/60 Hz)	0349 311 420
Digital instrument	0349 302 598
Transformer for CO <sub>2</sub> heater (42V 50/60 Hz)	0349 302 250

## Wear parts

## Origo™ Mag C171/C201/C251

Wire Ø mm	Wire type	1 Feed roller	2 Pressure roller	3 Inlet nozzle	4 Insert tube	5 Outlet nozzle	Groove type
0.6 / 0.8	Fe, Ss, C	367556-001	455907-001	466074-001	455889-001	455886-001	V
0.8 / 1.0	Fe, Ss, C	367556-002	455907-001	466074-001	455889-001	455886-001	V
1.0 / 1.2	Fe, Ss, C	367556-003	455907-001	466074-001	455889-001	455886-001	V
1.0 / 1.2	Al	367556-004	455907-001	466074-001	455894-001	455885-001	U
	C=cored wire						

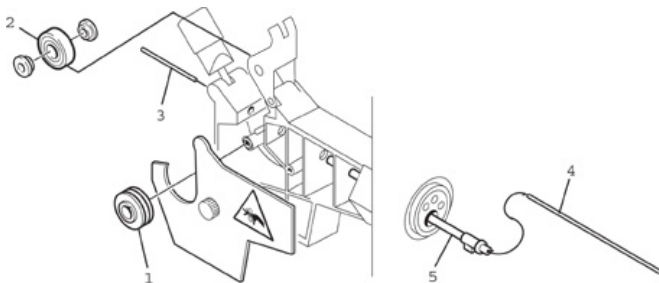

## Delivery content:

Origo™ Mag C171/C201; MXL™ 200 3 m (contact tip 0,8) assembled feed roller 0,6-0,8

Origo™ Mag C251; MXL™ 270 3 m (contact tip 1,0) assembled feed roller 0,8-1,0

All units; 3m mains cable with plug, 3m return cable with clamp, gas hose 1,5m, shelf for gas cylinder, attachment chain for gas cylinder, instruction manual.



## Quality accessories for the quality welder

ESAB offers a wide range of accessories. The complete range, along with product information, is available at our local web-sites, look at [www.esab.com](http://www.esab.com) or contact your local ESAB dealer.



**ESAB AB**  
 Box 8004  
 SE-402 77 GÖTEBORG SWEDEN  
 Phone: +46 31 50 90 00 Fax +46 31 22 04 49  
 E-mail: [info@esab.se](mailto:info@esab.se)  
[www.esab.com](http://www.esab.com)

